

STORMDRAIN & SEWER PIPES
 P1 - 12" S.D., L=50', S=0.005'/FT.
 P2 - 12" S.D., L=44', S=0.005'/FT.
 P5 - 12" S.D., L=48', S=0.005'/FT.
 P6 - 12" S.D., L=30', S=0.005'/FT.
 P7 - 12" S.D., L=48', S=0.005'/FT.
 P8 - 12" S.D., L=88', S=0.005'/FT.
 S1 - 8" SDR 35, L=140', S=0.004'/FT.
 S2 - 8" SDR 35, L=52', S=0.004'/FT.
 S3 - 8" SDR 35, L=26', S=0.004'/FT.
 S4 - 8" SDR 35, L=62', S=0.004'/FT.

Q CURVE DATA

CURVE #1 R=66.00', L=132.45', D=126°48'28", PC=0+19.58, PT=2+52.03
CURVE #2 R=110.00', L=78.15', D=74°62'76", PC=2+23.70, PT=3+01.85
CURVE #3 R=66.00', L=78.15', D=74°62'76", PC=2+23.70, PT=3+01.85
CURVE #4 R=75.00', L=40.10', D=30°63'08", PC=3+53.31, PT=3+93.41
CURVE #5 R=60.00', L=41.52', D=39°65'11", PC=0+50.88, PT=0+92.40
CURVE #6 R=75.00', L=51.12', D=39°05'09", PC=1+57.88, PT=2+09.00
CURVE #7 R=75.00', L=70.17', D=36°55'03", PC=2+36.24, PT=3+06.41
CURVE #8 R=110.00', L=22.57', D=11°75'40", PC=4+32.98, PT=4+55.55

STORMDRAIN STRUCTURES

CB#3 RIM 56.58, 12" INV. OUT 54.25
CB#4 RIM 52.20, 12" INV. OUT 48.22, 6" INV. IN 48.22
CB#3A RIM 53.33, 12" INV. OUT 51.23
CB#4A RIM 53.31, 12" INV. OUT 51.14
DMH#1 RIM 54.50, 6" INV. IN 48.88, 12" INV. IN 48.76, 12" INV. OUT 48.44
FI#2 RIM 52.50, 12" INV. OUT 49.00

SEWER STRUCTURES

SMH#1 RIM 55.96, 8" INV. IN 49.40, 8" INV. OUT 49.30
SMH#2 RIM 56.17, 8" INV. IN 49.74, 8" INV. OUT 49.64
SMH#3 RIM 55.90, 8" INV. IN 50.10, 8" INV. OUT 50.00
SMH#4 RIM 57.82, 8" INV. IN 51.34, 8" INV. OUT 51.24 TO SMH#4A
SMH#4A RIM 57.45, 8" INV. IN 51.00 FROM SMH#4, 8" INV. OUT 50.89
SMH#5 RIM 57.47, 8" INV. OUT 51.77
SMH#6 RIM 56.14, 8" INV. IN 50.61, 8" INV. OUT 50.51
SMH#7 RIM 55.56, 8" INV. OUT 51.09
SMH#8 RIM 55.90, 8" INV. OUT 50.86
SMH#9 RIM 56.62, 8" INV. IN 50.30, 8" INV. OUT 50.20
COMH#1 RIM 51.09, INV. IN 45.90

48" S.D., L=50', S=0.008'/FT, INV. 42.80
 SEE SECTION, SHT. 5

4" WATERMAIN
 4" VALVE
 INV. 42.40
 COMH #1
 RIPRAP OUTLET PROTECTION TYP.

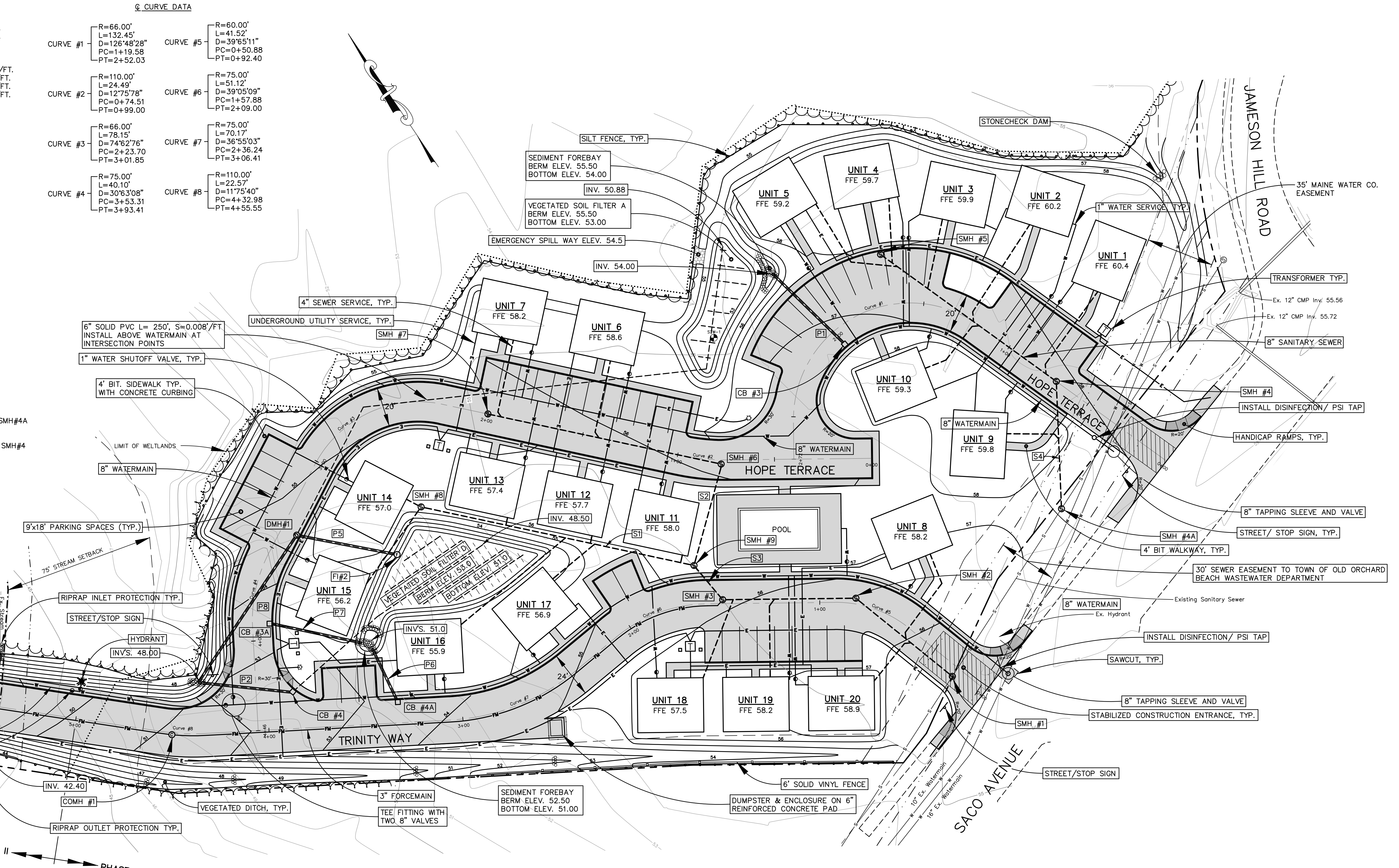

SYMBOL

5x56	SPOT GRADE
---	UNDERGROUND ELEC./TEL./CABLE
---	WATERMAIN
---	PRESSURE SEWER
---	SANITARY SEWER
---	SILT FENCE
---	STONE CHECK DAM
---	TRANSFORMER PAD
---	HYDRANT
---	UTILITY POLE
---	SANITARY SEWER MANHOLE

LEGEND

---	SPOT GRADE
---	UNDERGROUND ELEC./TEL./CABLE
---	WATERMAIN
---	PRESSURE SEWER
---	SANITARY SEWER
---	SILT FENCE
---	STONE CHECK DAM
---	TRANSFORMER PAD
---	HYDRANT
---	UTILITY POLE
---	SANITARY SEWER MANHOLE

- NOTES:**
1. MINIMUM 10' SEPARATION BETWEEN PROPOSED WATER AND PRESSURE SEWER MAINS AND SERVICES
 2. ALL STORMDRAIN PIPE SHALL BE ADS N12 OR EQUAL.
 3. INSTALL LOWPOINT SEDIMENT CONTROL BARRIERS AT ALL CATCH BASIN LOCATIONS, SEE DETAIL SHEET 7.
 4. SAWCUT EXISTING PAVEMENT AT PROJECT ENTRANCE AND WATER TRENCH, SEE DETAIL SHEET 7.
 5. FIELD INLET 1 SERVES AS AN EMERGENCY SPILLWAY FOR VEGETATED SOIL FILTER FIELD D.

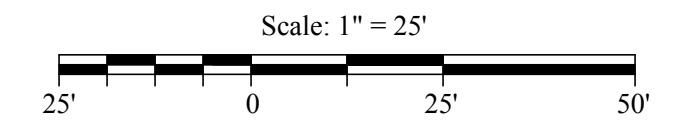

REVISION

NO.	DATE	DESCRIPTION
1	3/12/18	Rev'd Per Maine Water Review
2	4/2/18	Rev'd Per Maine Water Review

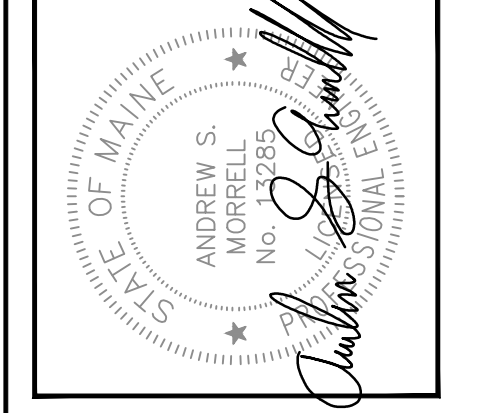

BH2M
 Engineers, Surveyors
 Berry, Huff, McDonald, Milligan Inc.
 28 State Street
 Portland, Maine 04108
 Tel: (207) 859-9771
 Fax: (207) 859-8250

FOR
 Church Street LLC
 2 Field Drive
 Old Orchard Beach, Maine

SITE UTILITIES & GRADING PLAN
 HOPE TERRACE & TRINITY WAY
 CHURCH STREET STATION
 SACO AVENUE
 OLD ORCHARD BEACH, MAINE

DESIGNED	W. Pelkey	DATE	April 2016
DRAWN	Dept.	SCALE	As Noted
CHECKED	A. Morrell	JOB. NO.	15134

SHEET
3

CONSTRUCTION

REPRODUCTION OR REUSE OF THIS DOCUMENT WITHOUT THE EXPRESSED WRITTEN CONSENT OF BH2M INC. IS PROHIBITED.